

HIGH AND LOW PRESSURE COMPRESSORS FOR PURE  
BREATHING AIR - NITROX AND TECHNICAL GASES

CATALOGUE  
**2019**

# PORTABLE COMPRESSORS

BREATHING AIR



**COLTRI**  
COMPRESSORS  
MADE IN ITALY

# COMPANY

The company has constantly evolved by closely following the rapid progress of production tools, thus creating more and more reliable products using cutting-edge equipment, such as robots and mechanical equipment with numerical controls.

In the Aerotecnica Coltri workshops, designing new products is predominately aimed at the quest for quality in order to create absolutely reliable and long-lasting products.



■ Every component of our pumping units is designed and manufactured in the Aerotecnica Coltri workshops. All the compressors found in this catalogue are assembled entirely within the company.

Aerotecnica Coltri's readiness to foresee advanced technology has led us to improve the operational quality and precision of our compressors.





# PRODUCTION



The production of high quality mechanical parts in Aerotecnica Coltri workshops is guaranteed by an efficient quality control system in the production cycle.

■  
DEA®, our equipment, has a significant role in measuring dimensions since it can detect the geometrical characteristics of the parts and anticipate their behaviour when used as pieces of more complex components.

■  
DEA® makes it possible to carry out precise measurements of objects with extremely variable dimensions and geometrical configurations as well as guaranteeing the production of the precise mechanical parts present in Coltri's compressors.

Through continuous refinement, Aerotecnica Coltri obtains quality certificates recognised around the world.

## QUALITY

UNI EN ISO 9001:2015



SISTEMA DI GESTIONE  
QUALITÀ CERTIFICATO



Breathing-Air Quality Testing Regulations EN12021

# BASIC

## LINE: PORTABLE





## DESCRIPTION

The world's most used portable compressors are part of our BASIC series. Compact and lightweight, this model range meets the high pressure breathing air needs of the diving world, recreational activities, firefighters and small paintball facilities. All equipped with the popular MCH 6 pumping unit, each is available with a petrol or electric motor, both three-phase and single-phase. The equipment includes a filling connection for a high pressure hose, from 232 to 300 bar, while a pressure maintaining valve, automatic condensate drain and autostop are available as optional extras. The frames are also available in stainless steel.



### MCH 3 LOW CONSUMPTION PUMPING UNIT



### MCH 6 PUMPING UNIT

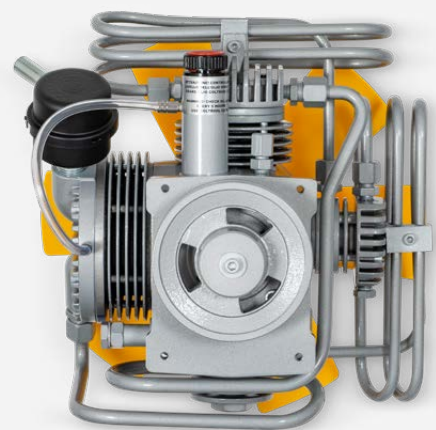

- 1 Intake filter
- 2 Intake valve 1st stage
- 3 Outlet valve 1st stage
- 4 Cooling pipe 1st-2nd stage
- 5 Intake valve 2nd stage
- 6 Outlet valve 2nd stage
- 7 Cooling pipe 2nd-3rd stage
- 8 Outlet valve 3rd stage
- 9 Final cooling pipe
- 10 Condensate separator
- 11 Pressure gauge
- 12 Safety valve
- 13 Flex hose

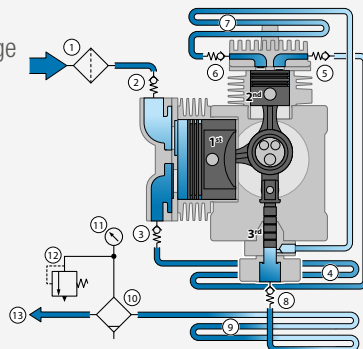

- 1 Intake filter
- 2 Intake valve 1st stage
- 3 Outlet valve 1st stage
- 4 Cooling pipe 1st-2nd stage
- 5 Outlet valve 2nd stage
- 6 Cooling pipe 2nd-3rd stage
- 7 Safety valve
- 8 Outlet valve 3rd stage
- 9 Cooling pipe 3rd-4th stage
- 10 Outlet valve 4th stage
- 11 Final cooling pipe
- 12 Condensate separator
- 13 Pressure gauge
- 14 Safety valve

- 15 Cooling pipe separator / filter
- 16 Purifier filter
- 17 Flex hose

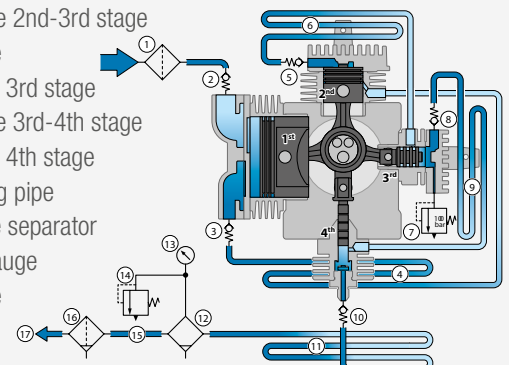

# TECHNICAL DATA

	EM 3	EM 6	ET 6	SH 6
<b>DRIVEN BY</b>	SINGLE-PHASE ELECTRIC MOTOR	SINGLE-PHASE ELECTRIC MOTOR	THREE-PHASE ELECTRIC MOTOR	HONDA PETROL ENGINE
<b>CHARGING RATE</b>	50 l/min - 3 m³/h 1.8 CFM FAD	90 l/min - 5.4 m³/h 3.2 CFM FAD	100 l/min - 6 m³/h 3.5 CFM FAD	100 l/min - 6 m³/h 3.5 CFM FAD
<b>FILLING TIME*</b>	36 min.	25 min.	20 min.	20 min.
<b>WORKING PRESSURE</b>	232 - 300 bar 3365 - 4351 psig	232 - 300 bar 3365 - 4351 psig	232 - 300 bar 3365 - 4351 psig	232 - 300 bar 3365 - 4351 psig
<b>NET WEIGHT Approx.</b>	39.5 kg - 87 lb	39.5 kg - 87 lb	39 Kg - 85 lb	37 kg - 82 lb
<b>NOISE</b>	91 dB	91 dB	95 dB	83 dB

\*Filling time cylinder 10 l-0/200 bar (measured by filling cylinder from 0 to 200 bar ±5%)

MCH 6 is designed for filling a single cylinder. It is neither designed or intended for filling cascade storage systems of any kind.

## STANDARD

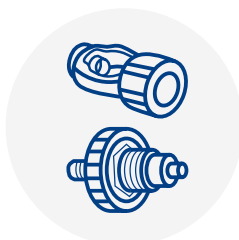

1 filling connection  
(among the ones available)



Hour meter  
(Only EM)



Filling hose  
1.2 m - 3.9 ft length

## OPTIONAL



Remote intake kit  
(Pag. 22)



Pressure maintaining valve  
+ BC filling valve



Autostop  
(Only EM/ET)  
(Pag. 22)



Automatic condensate drain  
(Only EM/ET) (Pag. 22)



Filling hoses  
length: 1.5 - 2 - 3 - 4 - 5 - 8 - 10 m  
4.9 - 6.5 - 9.8 - 13.1 - 16.4 - 26.2 - 32.8 ft



Frame  
in STAINLESS STEEL

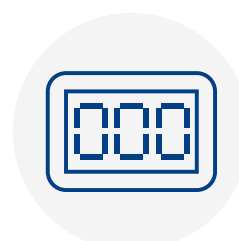

Hour-tacho meter  
Digital (Only SH HONDA)  
(Pag. 22)



# DIMENSIONS

**BASIC EM/ET**

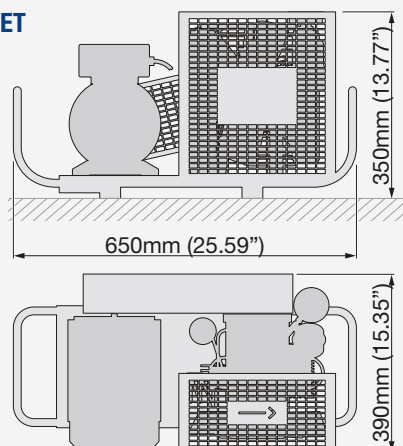

**BASIC SH**

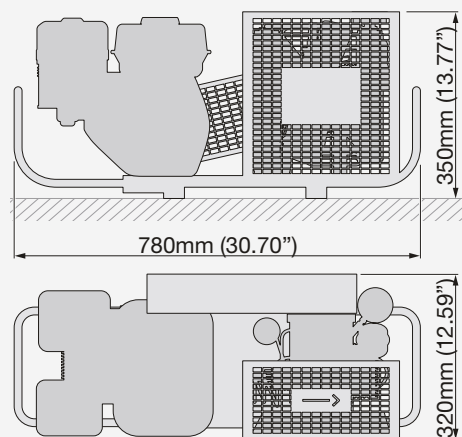

# MACHINE PARTS

**BASIC EM/ET**

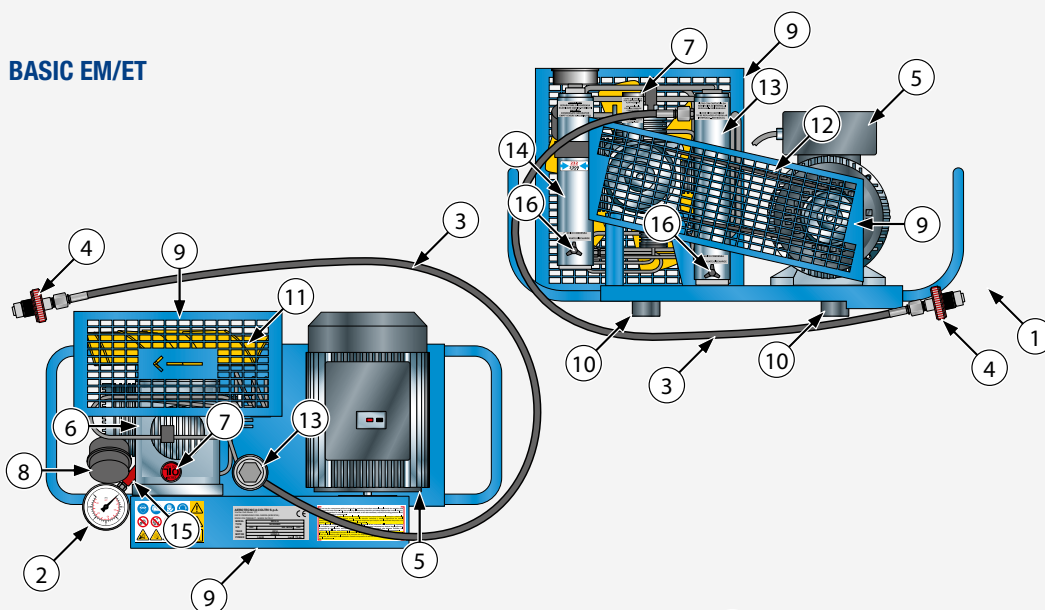

- 1 Frame
- 2 Pressure gauge
- 3 Hose
- 4 Refill valve
- 5 Electric motor
- 6 Compressor
- 7 Oil filler cap
- 8 Air filter
- 9 Safety mesh
- 10 Anti-vibration devices
- 11 Cooling fan
- 12 Belt
- 13 Purifier filter
- 14 Condensate separator
- 15 Safety valve
- 16 Condensate discharge

**BASIC SH**

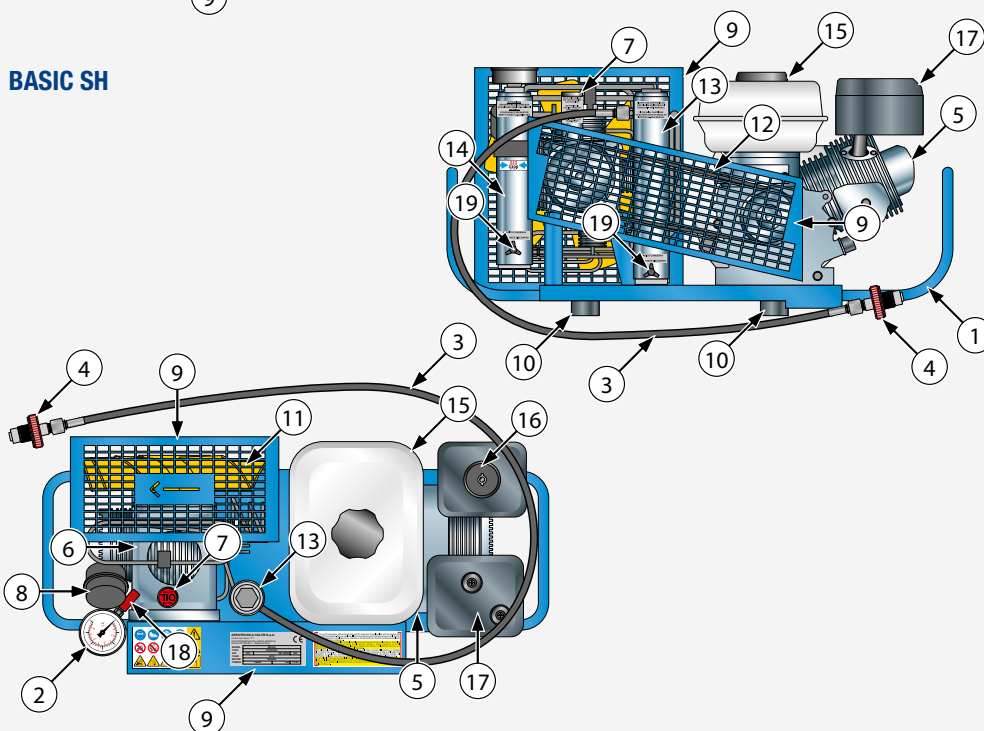

- 1 Frame
- 2 Pressure gauge
- 3 Hose
- 4 Refill valve
- 5 Internal combustion engine
- 6 Compressor
- 7 Oil filler cap
- 8 Air filter
- 9 Safety mesh
- 10 Anti-vibration devices
- 11 Cooling fan
- 12 Belt
- 13 Purifier filter
- 14 Condensate separator
- 15 Fuel tank
- 16 Internal combustion engine air filter
- 17 Internal combustion engine exhaust pipe
- 18 Safety valve
- 19 Condensate discharge

# COMPACT

## LINE: PORTABLE



MCH 6 EM COMPACT SINGLE-PHASE ELECTRIC MOTOR



## DESCRIPTION

The reinforced and more enclosed chassis makes the COMPACT range of compressors very popular in the naval sector. All equipped with the popular MCH 6 pumping unit, each is available with a petrol or electric motor, both three-phase and single-phase. The equipment includes a filling connection for a high pressure hose, from 232 to 300 bar. The pressure maintaining valve, automatic condensate drain and autostop are all available as optional extras. The frames are also available in stainless steel.



MCH 6 ET THREE-PHASE  
ELECTRIC MOTOR



MCH 6 SH HONDA

## MCH 6 PUMPING UNIT

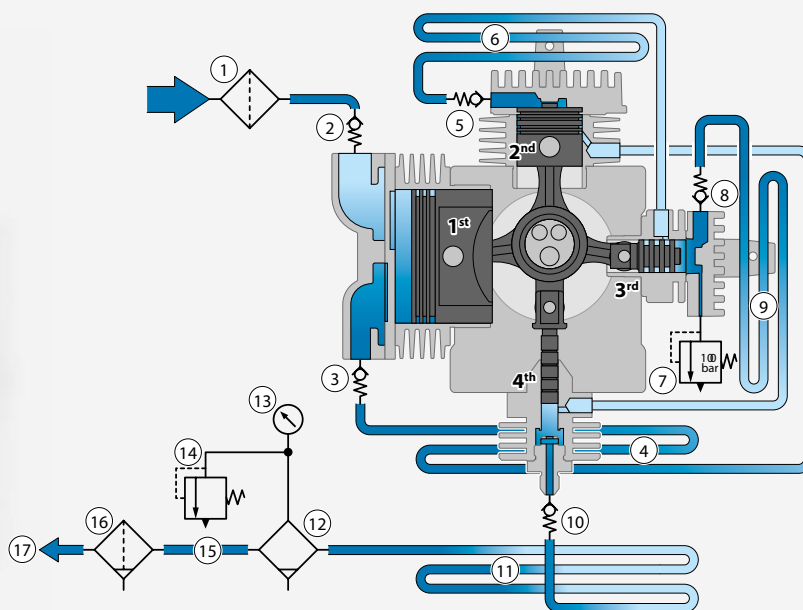
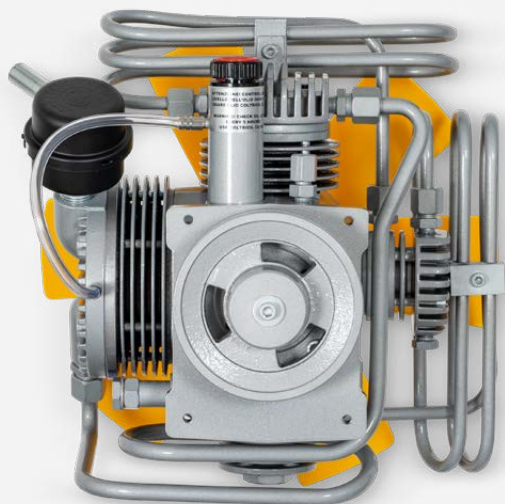

- |   |                            |    |                                 |
|---|----------------------------|----|---------------------------------|
| 1 | Intake filter              | 10 | Outlet valve 4th stage          |
| 2 | Intake valve 1st stage     | 11 | Final cooling pipe              |
| 3 | Outlet valve 1st stage     | 12 | Condensate separator            |
| 4 | Cooling pipe 1st-2nd stage | 13 | Pressure gauge                  |
| 5 | Outlet valve 2nd stage     | 14 | Safety valve                    |
| 6 | Cooling pipe 2nd-3rd stage | 15 | Cooling pipe separator / filter |
| 7 | Safety valve               | 16 | Purifier filter                 |
| 8 | Outlet valve 3rd stage     | 17 | Flex hose                       |
| 9 | Cooling pipe 3rd-4th stage |    |                                 |

# TECHNICAL DATA

	EM COMPACT 6	ET COMPACT 6	SH COMPACT 6
<b>DRIVEN BY</b>	SINGLE-PHASE ELECTRIC MOTOR	THREE-PHASE ELECTRIC MOTOR	HONDA PETROL ENGINE
<b>CHARGING RATE</b>	100 l/min - 6 m³/h - 3.5 CFM FAD	100 l/min - 6 m³/h - 3.5 CFM FAD	100 l/min - 6 m³/h - 3.5 CFM FAD
<b>FILLING TIME*</b>	20 min.	20 min	20 min.
<b>WORKING PRESSURE</b>	232 - 300 bar - 3365 - 4351 psig	232 - 300 bar - 3365 - 4351 psig	232 - 300 bar - 3365 - 4351 psig
<b>NET WEIGHT Approx.</b>	57.1 kg - 126 lb	56.7 Kg - 125 lb	47.3 kg - 104 lb
<b>NOISE</b>	91 dB	95 dB	83 dB

\*Filling time cylinder 10 l-0/200 bar (measured by filling cylinder from 0 to 200 bar ±5%)

MCH 6 is designed for filling a single cylinder. It is neither designed or intended for filling cascade storage systems of any kind.

## STANDARD

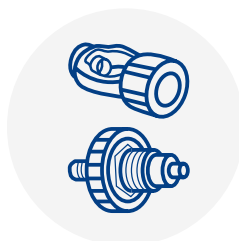

1 filling connection  
(among the ones available)



Hour meter  
(Only EM)



Filling hose  
1.2 m - 3.9 ft lenght

## OPTIONAL



Remote intake kit  
(Pag. 22)



Pressure maintaining valve  
+ BC filling valve



Autostop  
(Only EM/ET)  
(Pag. 22)



Automatic condensate drain  
(Only EM/ET) (Pag. 22)



Filling hoses  
lenght: 1.5 - 2 - 3 - 4 - 5 - 8 - 10 m  
4.9 - 6.5 - 9.8 - 13.1 - 16.4 - 26.2 - 32.8 ft



Frame  
in STAINLESS STEEL

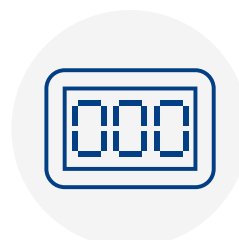

Hour-tacho meter  
Digital (Only SH HONDA)  
(Pag. 22)



Pressure regulator  
300/232 bar - 4351/3365 psig  
(Pag. 22)



# DIMENSIONS

COMPACT EM/ET

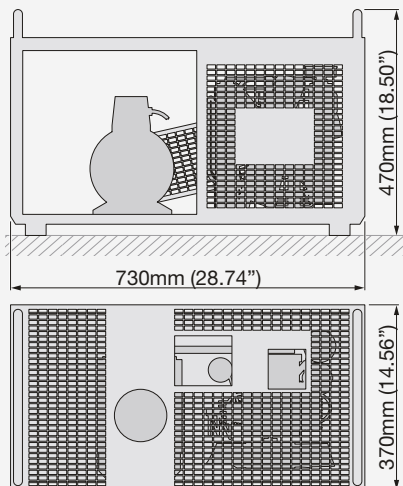

COMPACT SH

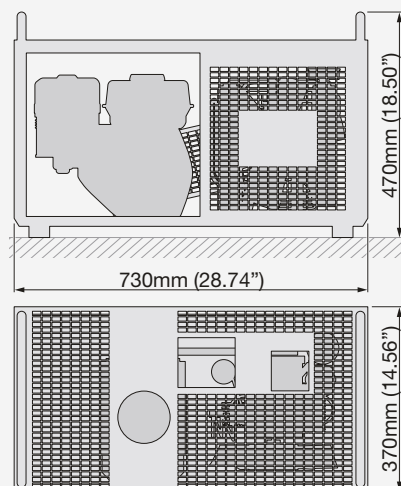

## MACHINE PARTS

COMPACT EM/ET

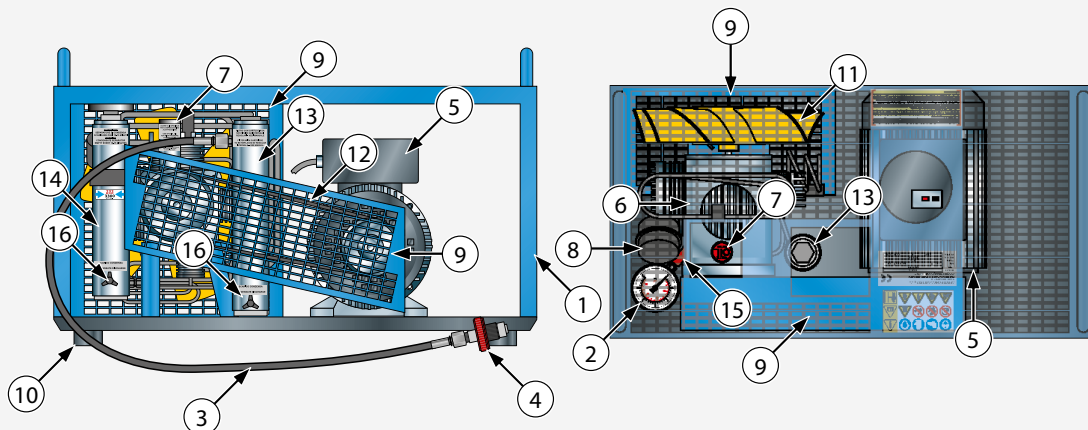

- |                  |                  |                           |                         |
|------------------|------------------|---------------------------|-------------------------|
| 1 Frame          | 5 Electric motor | 9 Safety mesh             | 13 Purifier filter      |
| 2 Pressure gauge | 6 Compressor     | 10 Anti-vibration devices | 14 Condensate separator |
| 3 Hose           | 7 Oil filler cap | 11 Cooling fan            | 15 Safety valve         |
| 4 Refill valve   | 8 Air filter     | 12 Belt                   | 16 Condensate discharge |

COMPACT SH

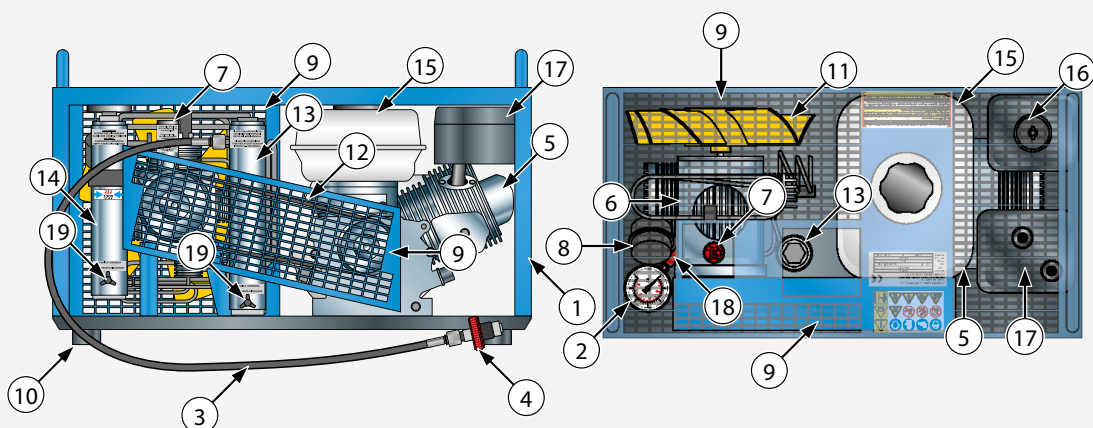

- |                              |                           |                         |  |
|------------------------------|---------------------------|-------------------------|--|
| 1 Frame                      | 6 Compressor              | 11 Cooling fan          | 16 Internal combustion engine air filter   |
| 2 Pressure gauge             | 7 Oil filler cap          | 12 Belt                 | 17 Internal combustion engine exhaust pipe |
| 3 Hose                       | 8 Air filter              | 13 Purifier filter      | 18 Safety valve                            |
| 4 Refill valve               | 9 Safety mesh             | 14 Condensate separator | 19 Condensate discharge                    |
| 5 Internal combustion engine | 10 Anti-vibration devices | 15 Fuel tank            |  |

# SILENT

## LINE: PERSONAL



MCH 6 EM SINGLE-PHASE ELECTRIC MOTOR



## DESCRIPTION

Providing the same performance specifications as every model equipped with the MCH 6 pumping unit, the Coltri breathing air compressors in the SILENT series are extremely quiet and the large space offered by the frame lets the Maxifilter system be used. Available with single-phase or three-phase electric motor and integrated control panel with timer, it is equipped with an automatic condensate drain and autostop as standard. The equipment includes a filling connection for a high pressure hose, from 232 to 300 bar.



MCH 6 EM SINGLE-PHASE ELECTRIC MOTOR

## MCH 6 PUMPING UNIT

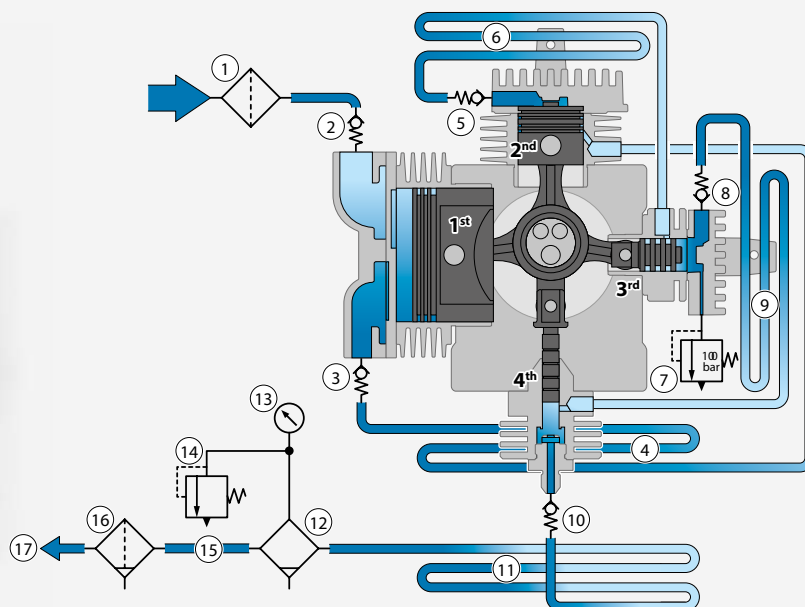
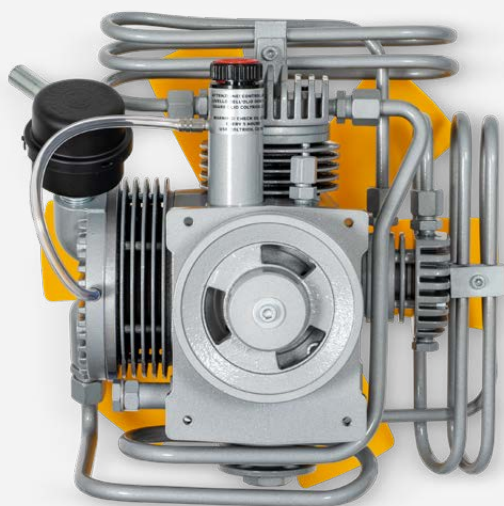

- |                              |                                    |
|------------------------------|------------------------------------|
| 1 Intake filter              | 10 Outlet valve 4th stage          |
| 2 Intake valve 1st stage     | 11 Final cooling pipe              |
| 3 Outlet valve 1st stage     | 12 Condensate separator            |
| 4 Cooling pipe 1st-2nd stage | 13 Pressure gauge                  |
| 5 Outlet valve 2nd stage     | 14 Safety valve                    |
| 6 Cooling pipe 2nd-3rd stage | 15 Cooling pipe separator / filter |
| 7 Safety valve               | 16 Purifier filter                 |
| 8 Outlet valve 3rd stage     | 17 Flex hose                       |
| 9 Cooling pipe 3rd-4th stage |                                    |



# TECHNICAL DATA

	EM	ET
DRIVEN BY	SINGLE-PHASE ELECTRIC MOTOR	THREE-PHASE ELECTRIC MOTOR
CHARGING RATE	80 l/min - 4.8 m³/h - 2.8 CFM FAD	100 l/min - 6 m³/h - 3.5 CFM FAD
FILLING TIME*	25 min.	20 min.
WORKING PRESSURE	232 - 300 bar - 3365 - 4351 psig	232 - 300 bar - 3365 - 4351 psig
NET WEIGHT Approx.	84.5 kg - 186 lb	84.5 kg - 186 lb
NOISE	66 dB	66 dB

\*Filling time cylinder 10 l-0/200 bar (measured by filling cylinder from 0 to 200 bar ±5%)  
MCH 6 is designed for filling a single cylinder. It is neither designed or intended for filling cascade storage systems of any kind.

## STANDARD

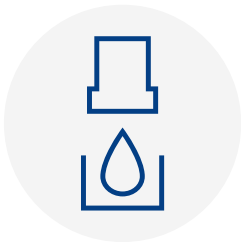

Automatic condensate drain  
with tank



Maxifilter  
filtration  
(Pag. 25)

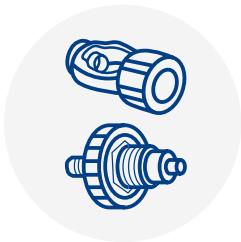

1 filling connection  
(among the ones available)



Hour meter



Filling hose  
1.2 m - 3.9 ft length



Autostop  
(Pag. 22)

## OPTIONAL

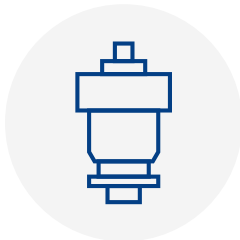

Pressure maintaining valve  
+ BC filling valve



Filling hoses  
length: 1.5 - 2 - 3 - 4 - 5 - 8 - 10 m  
4.9 - 6.5 - 9.8 - 13.1 - 16.4 - 26.2 - 32.8 ft

## DIMENSIONS

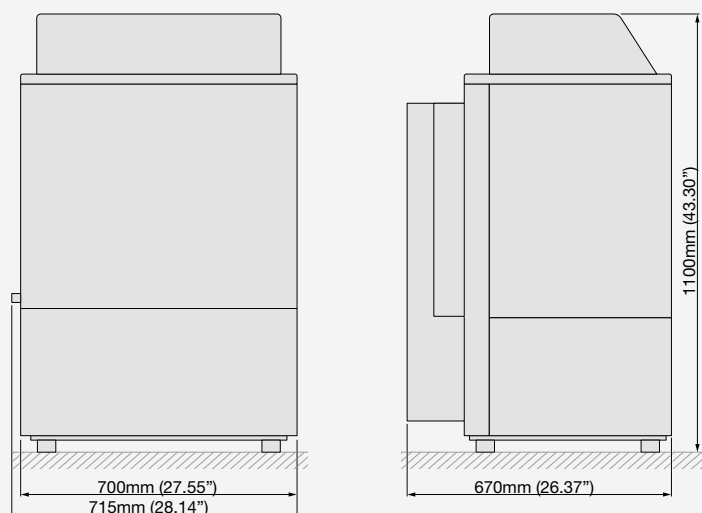

## MACHINE PARTS

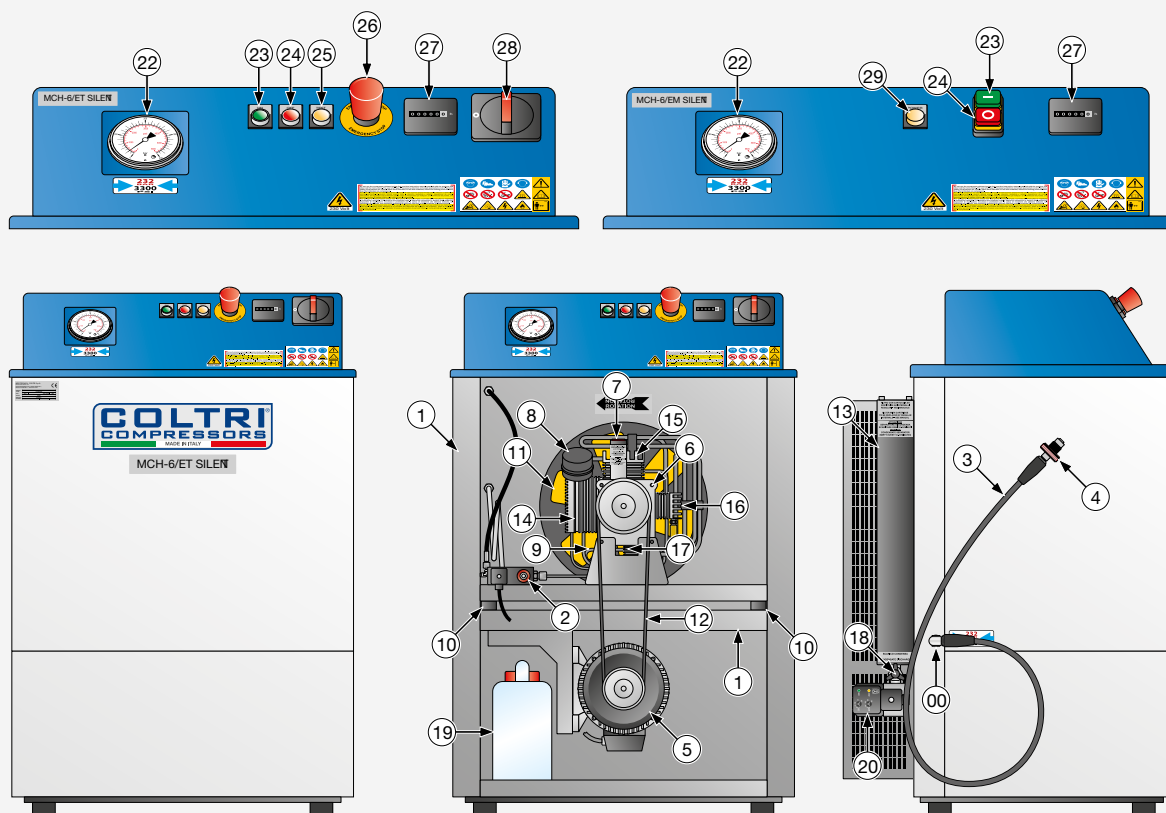

- |                           |                                   |                                    |
|---------------------------|-----------------------------------|------------------------------------|
| 1 Frame                   | 11 Cooling fan                    | 21 Refill hoses connection         |
| 2 Safety valve            | 12 Belt                           | 22 Working pressure gauge          |
| 3 Hose                    | 13 Purifier filter                | 23 ON pushbutton                   |
| 4 Refill valve            | 14 1st Stage                      | 24 STOP pushbutton                 |
| 5 Engine                  | 15 2nd Stage                      | 25 Condensate discharge pushbutton |
| 6 Compressor              | 16 3rd Stage                      | 26 Emergency pushbutton            |
| 7 Oil filler cap          | 17 4th Stage                      | 27 Hour counter                    |
| 8 Air filter              | 18 Condensate discharge valve     | 28 Selector switch ON/OFF          |
| 9 Oil discharge plug      | 19 Condensate collection can      | 29 Power indicator light           |
| 10 Anti-vibration devices | 20 Automatic condensate discharge |                                    |



# EOLO 330

LINE: THIRD LUNG

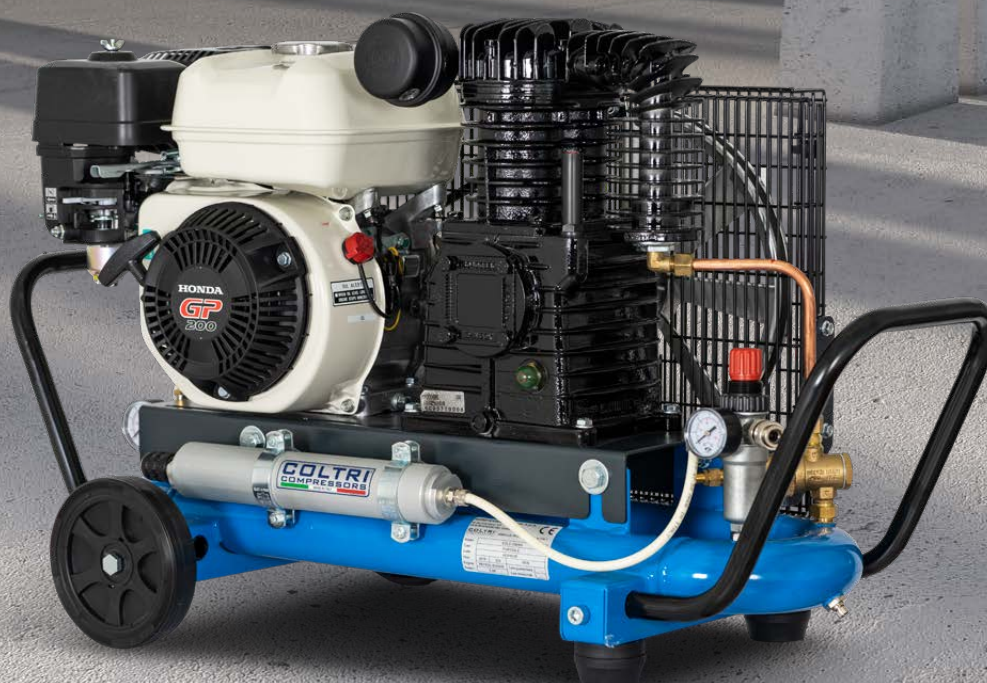

EOLO 330 SH HONDA

## DESCRIPTION

The EOLO 330 series consists of low pressure Coltri breathing air compressors for professional use with a three-cylinder pumping unit guaranteeing excellent performance. Equipped with an interchangeable filter cartridge, it is ideal for working underwater or with ventilated helmets. The engines available are single-phase or three-phase electric, or Honda petrol. They are extremely easy to handle thanks to the built-in tank and trolley.



EOLO 330 ET THREE-PHASE ELECTRIC MOTOR

## PRESSURE CIRCUIT

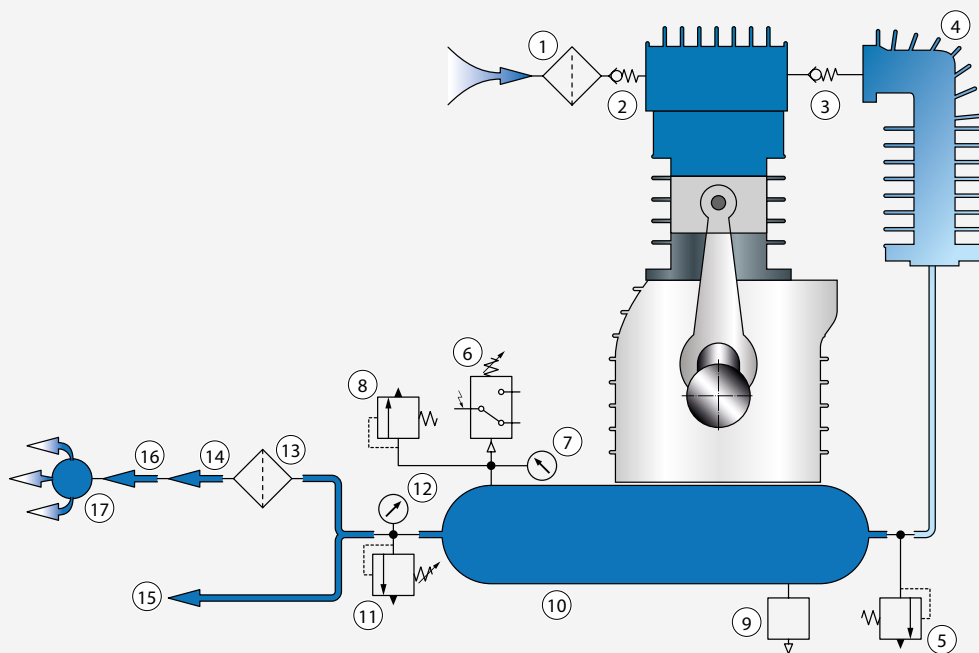

- |  |  |  |
|--|--|--|
| <b>1</b> Intake filter   | <b>6</b> Automatic pressure switch<br>(for compressors equipped with<br>electric motor only) | <b>11</b> Pressure regulator             |
| <b>2</b> Intake valve  | <b>7</b> Tank pressure gauge   | <b>12</b> Outlet pressure gauge          |
| <b>3</b> Outlet valve  | <b>8</b> Safety valve  | <b>13</b> Purifier filter                |
| <b>4</b> Radiator  | <b>9</b> Condensate discharge valve  | <b>14</b> Filtered breathable air outlet |
| <b>5</b> Vacuum valve<br>(for compressors equipped with<br>combustion engine only) | <b>10</b> Air tank   | <b>15</b> Non-breathable air outlet      |
|  |  | <b>16</b> Non-toxic hose (optional)      |
|  |  | <b>17</b> Breathing regulator (optional) |



# TECHNICAL DATA

	EOLO 330 EM	EOLO 330 ET	EOLO 330 SH
DRIVEN BY	SINGLE-PHASE ELECTRIC MOTOR	THREE-PHASE ELECTRIC MOTOR	HONDA PETROL ENGINE
AIR DELIVER	330 l/min - 19.8 m³/h 11.6 CFM FAD	330 l/min - 19.8 m³/h 11.6 CFM FAD	330 l/min - 19.8 m³/h 11.6 CFM FAD
WORKING PRESSURE	8 bar / 120 psig	8 bar / 120 psig	8 bar / 120 psig
NET WEIGHT Approx.	55 kg - 121 lb	55 kg - 121 lb	55 kg - 121 lb
NOISE	81.7 dB	83 dB	100.5 dB
TANK CAPACITY	4.5 l	4.5 l	4.5 l

## STANDARD



Autostop  
(Pag. 22)



Suction filter  
(Pag. 22)

## OPTIONAL



Regulator  
(Pag. 22)

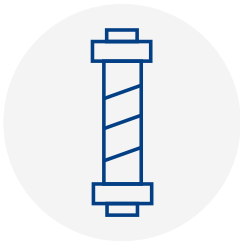

Food grade floating  
LP pipe  
(Pag. 22)

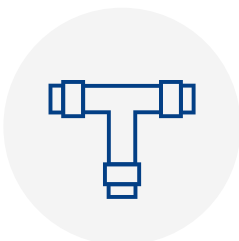

Double outlet  
(Pag. 22)



Remote intake kit  
(Pag. 22)

# DIMENSIONS

EOLO 330 SH

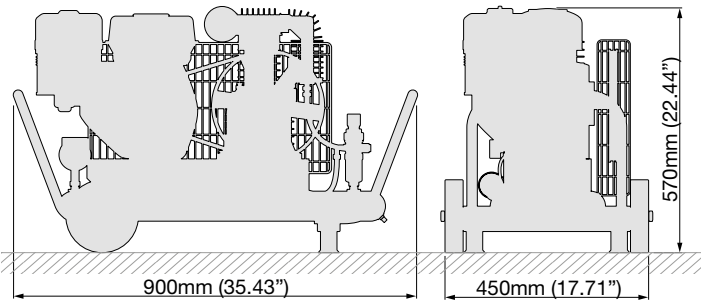

EOLO 330 EM-ET

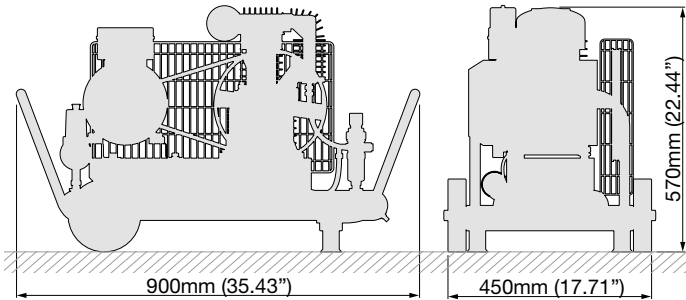

# MACHINE PARTS

## EOLO 330 SH

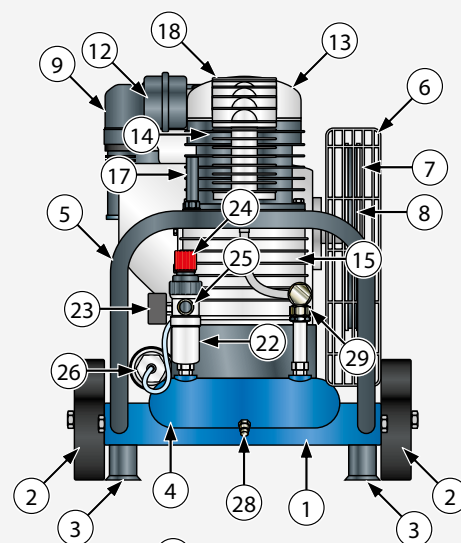
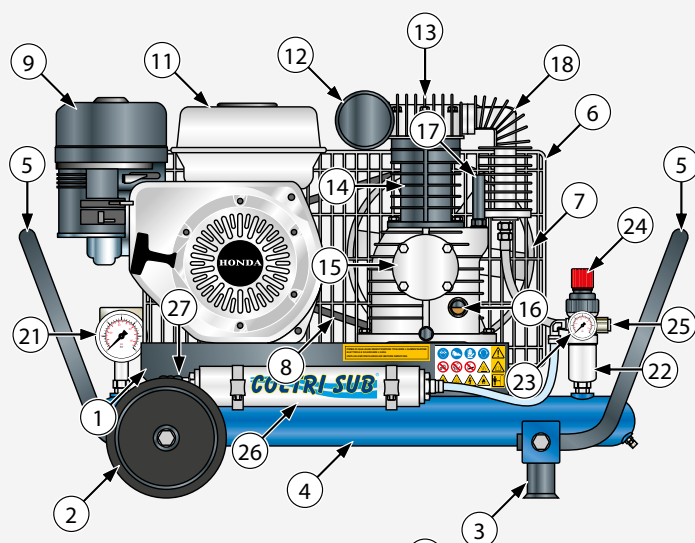

## EOLO 330 EM-ET

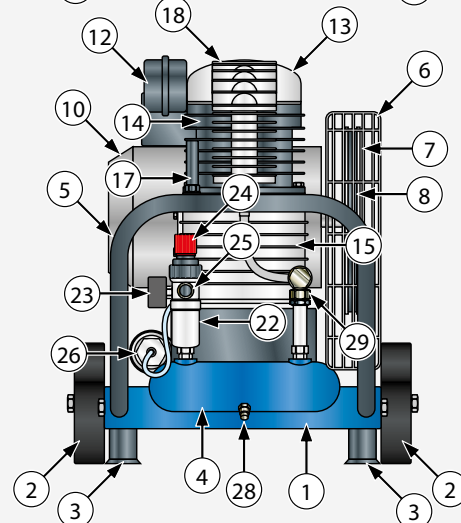
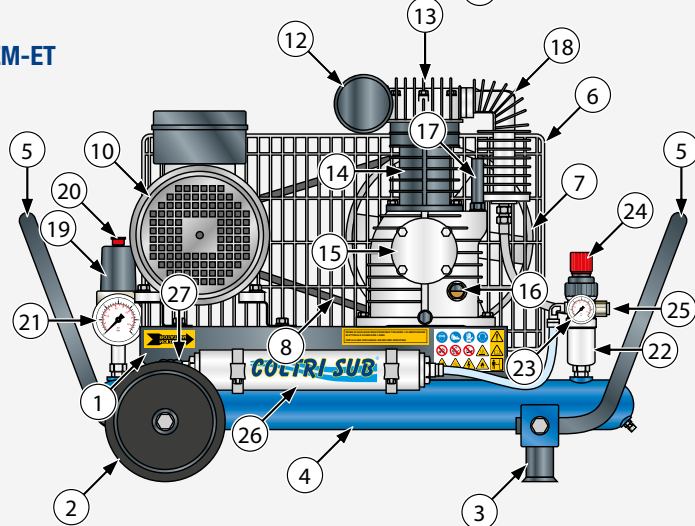

- |                              |                        |                                   |
|------------------------------|------------------------|-----------------------------------|
| 1 Frame                      | 11 Fuel tank           | 21 Tank pressure gauge            |
| 2 Rubber wheels              | 12 Air filter          | 22 Pressure regulator             |
| 3 Elastic stop feet          | 13 Cylinder heads      | 23 Outlet pressure gauge          |
| 4 Air tank                   | 14 Cylinders           | 24 Pressure regulation valve      |
| 5 Carry handle               | 15 Monobloc            | 25 Professional-use fast coupling |
| 6 Fan-chain guard mesh       | 16 Oil level indicator | 26 Purifier filter                |
| 7 Cooling fan                | 17 Oil filler cap      | 27 Non-toxic hose rapid coupling  |
| 8 Belt                       | 18 Radiator            | 28 Condensate discharge valve     |
| 9 Internal combustion engine | 19 Pressure switch     | 29 Vacuum valve                   |
| 10 Electric motor            | 20 Start-stop switch   |                                   |



## OPTIONALS ACCESSORIES MCH 6

### DIGITAL HOUR-TACHO METER

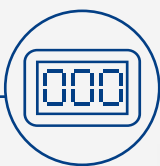

#### CODE

13-04-0210  
(Only Honda)

### SUCTION FILTER CARTRIDGE

Only for MCH 6



#### CODE

SC000345

### REMOTE INTAKE KIT

ADAPTER 1/2"

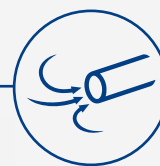

#### CODE

HC010302

3 M - 9.8 FT LENGHT PIPE AND 20 MM - 0.78" DIAMETER

### AUTOSTOP



#### CODE

SC000521

### AUTODRAIN WITH TIMER



#### CODE

SC000522

### PRESSURE REGULATOR

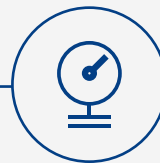

#### CODE

SC000531

## OPTIONALS ACCESSORIES EOLO - THIRD LUNGS

### FOOD GRADE FLOATING LP PIPE



#### CODE

HC010160



### REGULATOR



#### CODE

HC010170

### REMOTE INTAKE KIT

ADAPTER 1/2"



#### CODE

HC010302

3 M - 9.8 FT LENGHT PIPE AND 20 MM - 0.78" DIAMETER

### DOUBLE OUTLET

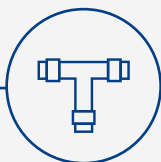

#### CODE

HC010180

### SUCTION FILTER

Only for EOLO 330



#### CODE

HC010301

# ACCESSORIES AND EXPENDABLE MATERIALS

## AIR FILTER CARTRIDGE



**A** CODE SC000340/ABS  
WITH MOLECULAR SIEVE AND  
ACTIVATED CARBON

**B** CODE SC000340/ABS/SM  
WITH MOLECULAR SIEVE

**C** CODE SC000340/ABS/CARB  
WITH ACTIVATED CARBON

**D** CODE SC000340/ABS/CO-CATALYST  
WITH MOLECULAR SIEVE,  
ACTIVATED CARBON  
AND CO-CATALYST

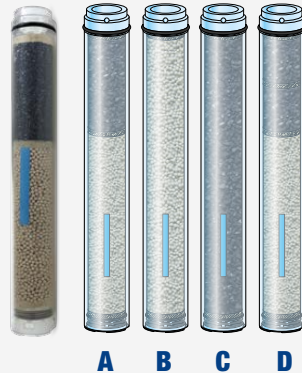

## MAXIFILTER FOR MCH 6 SILENT POLYPROPYLENE



**A** CODE SC000440/PP  
WITH MOLECULAR SIEVE  
AND ACTIVATED CARBON

**B** CODE SC000440/PP/SM  
WITH MOLECULAR SIEVE

**C** CODE SC000440/PP/CARB  
WITH ACTIVATED CARBON

**D** CODE  
SC000440/PP/CO-CATALYST  
WITH MOLECULAR SIEVE,  
ACTIVATED CARBON AND  
CO-CATALYST



## CAPS & DISCS KIT

For MCH 6 SILENT - AIR FILTER CARTRIDGE

CODE

13-05-0601/R  
6 pieces kit



## FELTS

For MAXIFILTER

CODE

13-00-0800  
for Maxifilter  
6 pieces kit



## SYNTHETIC COLTRI OIL 157



- Fully synthetic oil with high viscosity index
- Excellent performance at high and low temperature

CODE 1 l

SC000795

## MOTOR OIL FOR PETROL AND DIESEL ENGINES



CODE 600 ml

SC000431

## ACTIVATED CARBON

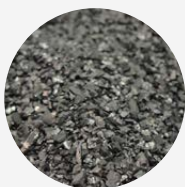

CODE

SC000350 1 l

## MOLECULAR SIEVE



CODE

SC000380 1 l

## CO CATALYST

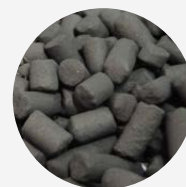

CODE

SC000355 1 kg

[illegible]



[illegible]

**AEROTECNICA COLTRI® S.p.A.**

Via dei Colli Storici 177  
25015 Desenzano del Garda  
Brescia - ITALY

Tel: +39.030.9910301

+39.030.9910297

Fax: +39.030.9910283

**[www.coltri.com](http://www.coltri.com)**

[info@coltri.com](mailto:info@coltri.com)

CAT/COMPORATI/EN ED. 2019 - 009

**Some technical characteristics and products presented in this catalog  
may be modified or substituted without prior notice.**

